

# SPECIFICATIONS

**Product Model Numbers**  
**Ironing Centers:**  
**NE-242 Swivel**

**Dimensions (Actual Size)**

Overall height: 47 7/8"  
Overall width: 15"  
Overall depth including door: 4 1/4"

**Additional Information**

- Unit may be surface mounted only (unit extends approximately 4 1/4" room)
- See table below to determine desired ironing board height above the floor.
- Unit can be provided with a left hinged door upon request. Right hinge is standard.
- Comes standard with birch veneer door.
- Door opens approximately 180°. Allow at least 16" to the side of the unit for door to swing open (door hinges on full length piano hinge.)
- Options include: Oak, maple, pine, or white raised panel door, flat white door, glass mirrored door, or no door, swivel (does not include 4" height adjustment), sleeveboard, and iron.

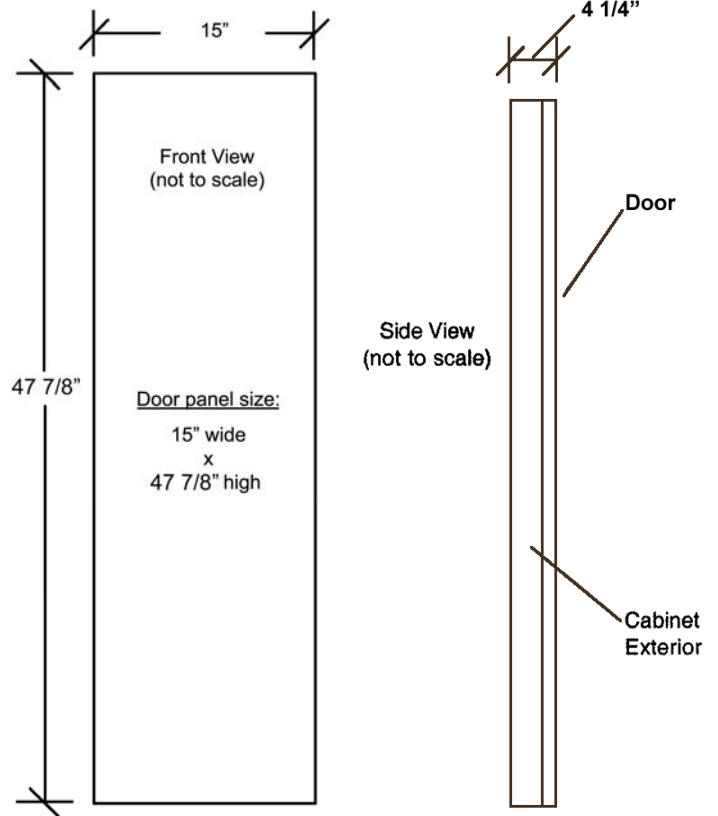

**Top View**  
(not to scale)



Height Adjustments	
Cut Opening Above floor	Board Height
32"	39"
31"	38"
30	37"
29"	36"
28"	35
27"	34"
26"	33"
25"	32"
24"	31"
23"	30"
22"	29"

## Page 2

Measurements when board is lowered  
(not to scale)

Unit can be provided with a left hinged door upon request. Right hinge is standard.

